

RESERVATION FORM

Fitzmaurice's Caravan Park

Tramore, Co. Waterford, Ireland. | Tel: (051) 381968 / (051) 381466
 Email: info@fitzmauricescaravanpark.com
 Web: www.fitzmauricescaravanpark.com

Name:
 (Block Letters)

Address:

.....

.....

Telephone:

Email:

Please reserve for me one berth length

Mobile Home Type

for weeks @ € per week

from 3.00 p.m. Saturday

to 11.00 a.m. Saturday

Mobile Home will be occupied by

adults and children aged

TOTAL HIRE CHARGE: €

Deposit enclosed (€100 per week) €

Balance: €

€

I enclose Cheque Money Order for € Deposit and have read and agree to the Conditions of Hire.

I will pay the **Balance** plus €50 **Damage Deposit** on arrival.

Signature:

Date: **Cut off and Post**

HIRE RATES PER WEEK 2011

MOBILE HOMES Serviced				New Delta
Type	E	G	H	K
Length in feet	24	26	28	28
No. of Berths	7	6	7	6
	€	€	€	€
1 April - 23 April	269	289	299	329
23 April - 18 June	369	389	399	429
18 June - 2 July	449	469	479	499
2 July - 16 July	489	519	529	569
16 July - 23 July	519	569	579	629
23 July - 30 July	559	610	619	669
30 July - 13 Aug	579	619	629	679
13 Aug - 20 Aug	549	599	610	659
20 Aug - 27 Aug	459	489	499	549
27 Aug - 30 Sept	349	389	399	459
Easter 22 - 25 April	229	249	259	279
May B/H-day 29 Apr - 2 May	210	230	240	259
June Weekend 3 - 6 June	249	269	279	299

* MINI WEEK * SHORT BREAKS
 ANY 2, 3, 4 NIGHTS

*** Electricity & Gas Supplied Free***

THE ABOVE PRICES INCLUDE V.A.T. @ 13.5%

FULLY SERVICED: Type E
 24ft Mobile Homes have
 Fridge, Water and Toilet - NO Shower

Type G, H & K are FULLY SERVICED
 Fridge, H.C. Water, Toilet & Shower

SWIMMING & SURFING:

Tramore Strand is three miles long and is smooth and shelving. There is excellent bathing. Guillameen Cove is superb for deep water swimming. There are short sandy beaches at Annestown (7 miles) and Bonmahon (12 miles).



AMUSEMENT ARCADES:

Tramore has all the fun of the fair available: Golf, Boating, Lakes, Miniature Railway, Childrens' Play Centre.

GOLF: There is an excellent 18-Hole Golf Course with Club House. Open competitions are held at Easter, Whit, July and August. There are three 18-Hole Pitch and Putt courses, a Putting green and Golf Driving Range.

FISHING: Good fishing in the bay for Whiting, Gunard, Mackerel, Sea Trout and Bass. Boats, tackle and bait are available locally. Shore angling is very popular.

TENNIS: Tramore Lawn Tennis Club is on the outskirts of the Town. Visitors are welcome.



RACING: Horse Racing is held in Tramore 9th & 10th April, 3rd & 4th May, 11th, 12th 13th & 14th August

CINEMA: Waterford Storm Cinemas

NIGHT LIFE: Discos, Hotels, Family Entertainment & Late Bars

GREYHOUND RACING: Kilcohan Park, Waterford (7 miles) - Fridays and Saturdays (in season) and annually for the full week in mid-August.

LATE NIGHT MEALS: Hotels open for meals until 9 p.m. Grill Bars until 12 midnight.

OTHER ATTRACTIONS IN TRAMORE: Splashworld, Pirates Adventure and Run Amuck

WATERFORD: Regular bus service to Waterford City with its many shops and historic attractions like Reginald's Tower, Heritage Centre, Arts Centre etc. Visit the world famous Waterford Crystal Factory and see the glass being made and on display.



TALL SHIPS RACE: Waterford 30th June - 3rd July 2011

CONDITIONS OF HIRE

- Hire periods commence after 3 p.m. on Saturday and end at 11 a.m. on Saturday. Rental periods during July and August are from Saturday to Saturday only. Outside these months, Mobile Homes can be hired on any day of the week and for shorter periods.
- A Deposit of €100 Per Week** is required at the time of booking. The balance of hire charge is payable in cash or bank draft at the commencement of hire.
- The Management reserves the right to decline accommodation. NO REFUND will be made if a hirer is requested to leave a Mobile Home, or leaves of his own accord before the expiration of the booking.
- Should the Mobile Home booked not be available due to unforeseen circumstances, we reserve the right to offer an alternative, or to cancel the reservation and to refund the amount paid in advance in full settlement of any or all claims.
- Damage Deposit:** At commencement of hire a damage deposit of €50 will be collected from each hirer. The Management reserves the right to collect a larger damage deposit. This will be refunded at the time of check-out provided no damage has occurred to the Mobile Home or equipment during the rental period and that it has been left in a clean and orderly condition. Your Mobile Home will be checked before your departure.
- Cancellations: In the event of a booking being cancelled with at least three week's notice, 50% of the deposit will be refunded if we are successful in re-letting the Mobile Home, otherwise the full deposit is forfeited.
- If a Mobile Home is not occupied before 6 p.m. on the date of arrival and the Management is not notified, the mobile home will be considered cancelled and will be re-let. Deposit will be forfeited.
- All Mobile Homes are fully equipped **EXCEPT FOR LINEN.** Please bring with you - Sheets, Pillow Slips, Towels, Dish Cloths. You can also rent Sheets at the Park (if booked in advance) at €9 per pair and Pillow Cases at €4 per pair.
- It is an express Condition of Hire that the Management be relieved of liability for any accident or loss or damage which may be sustained by the Hirer (or their property) whether such loss or damage is caused by the negligence of the Management or its servants or otherwise.
 The company is not responsible for any loss of valuables or property left in the home or on site during the stay or on departure.



FULLY SERVICED

MOBILE HOMES

TYPE E

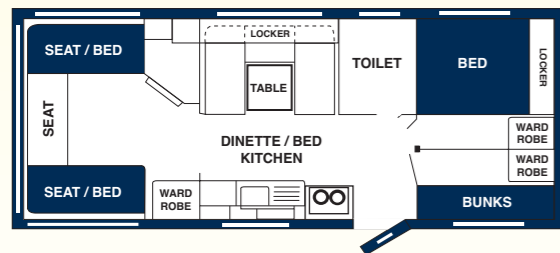

7 Berth: (24ft x 10ft) Fully Serviced

Room-1 Double Bed, Room-2 Bunks. Open Plan - 1 Double Bed & 2 Singles
Gas Cooking, Toilet and Running Water, No Shower, Fridge, Free Gas & Electricity.

TYPE G

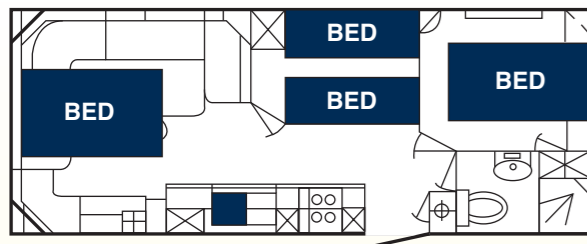

6 Berth: (26ft x 10ft) Fully Serviced

Room-1 Double Bed, Room-2 Singles + 1 Bunk. Open Plan - 1 Double Bed
Toilet, Shower, H/C Water, Gas Cooking, Fridge, Free Gas & Electricity.

LIST OF EQUIPMENT

The Caravan /Mobile Home contains:
Blankets, Pillows, Cups & Saucers, Side Plates, Dinner Plates, Dessert Dishes, Drinking Glasses, Egg Cups, Knives, Forks, Dessert Spoons, Tea Spoons.
One of each of the following: Sugar Bowl, Milk Jug, Ash Tray, Cutlery Tray, Bread Knife, Fish Slice, Tin Opener, Bread Bin, Bread Board, Kettle, Tea Pot, Frying Pan, Grill Pan, Roasting Dish, Basin, Brush & Mop; plus three Saucepan's.

FULLY SERVICED

MOBILE HOMES

TYPE H

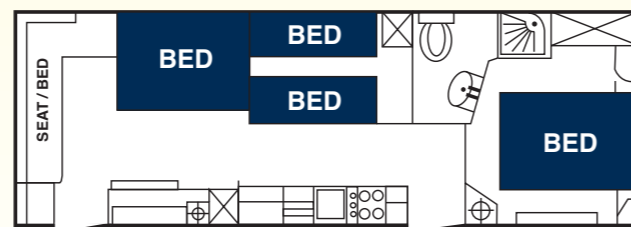

7 Berth: (28ft x 10ft) Fully Serviced

Room-1 Double Bed, Room-2 Singles. Open Plan - 1 Double + 1 Single.
Toilet, Shower, H/C Water, Gas Cooking, Free Gas & Electricity.

TYPE K

"NEW 2011" DELTA SANTANA



6 Berth: (28ft x 10ft) Fully Serviced

Room-1 Double Bed, Room-2 Singles. Open Plan - 1 Double Bed
Toilet, Shower, H/C Water, Gas Cooking, Fridge, Free Gas & Electricity.



FITZMAURICE'S
CARAVAN & CAMPING PARK



TRAMORE Co. WATERFORD, IRELAND.

Tel. (051) 381968/(051) 381466

Email: info@fitzmauricescaravanpark.com

Web: www.fitzmauricescaravanpark.com

FACILITIES INCLUDE:

- MODERN TOILETS • SHOWERS • SHAVER POINTS
- LIGHTING STANDARDS • TARMACADAM ROADS
- WATERPOINTS THROUGHOUT THE PARK
- GAMES / TELEVISION ROOM • SHOP
- LAUNDRY ROOM • WASHING MACHINES • SPIN DRYERS

OUR CARAVAN PARK IS ONLY 300 YARDS FROM THE BEACH

RESIDENT MANAGER ALWAYS AVAILABLE

SHOP OPEN DURING PEAK SEASON
FROM 8.30 A.M. TO 10.30 P.M.

STOCKED WITH:

- BREAD • MILK • MEATS • GROCERIES
- ICE CREAM • SWEETS • FROZEN FOODS
- FRUIT • VEGETABLES • FANCIES ETC.

Bórd Fáilte Registered

TRAMORE

2011 IRELAND



FITZMAURICE'S

CARAVAN HOLIDAYS

Tramore, Co. Waterford, Ireland.

Tel.: (051) 381968 / 381466

Email: info@fitzmauricescaravanpark.com

Web: www.fitzmauricescaravanpark.com

